

Pullaway® L Bead

Got a messy job that needs maximum masking protection? This bead's for you! This bead creates a smooth finished edge when drywall meets another substrate. Its removable strip pulls out easily after finishing, and provides up to ½" of masking protection.



Installation Guide

Technical Specs

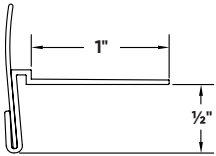

Scan Below for
Installation Video



Before Installation:

Measure, cut and dry fit the bead.

Step 1:

Coat the bead and the drywall with Trim-Tex 847 Spray Adhesive.

Step 2:

Press the bead in place, applying pressure to the mud legs.

Step 3:

Staple every 6"-8" using ½" stainless steel staples.

Step 4:

Finish with two coats of drywall compound.

Step 5:

Once the second coat dries, pull away the masking strip.

Step 1:



Step 2:

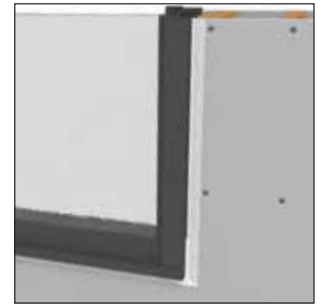

Step 3:



Step 4:

